

THIS DRAWING IS THE PROPERTY OF ATELIER VAMA. IT SHOULD NOT BE USED, COPIED OR REPRODUCED WITHOUT THEIR WRITTEN PERMISSION.

DRAWING REFERENCES	
DRG. NO	TITLE

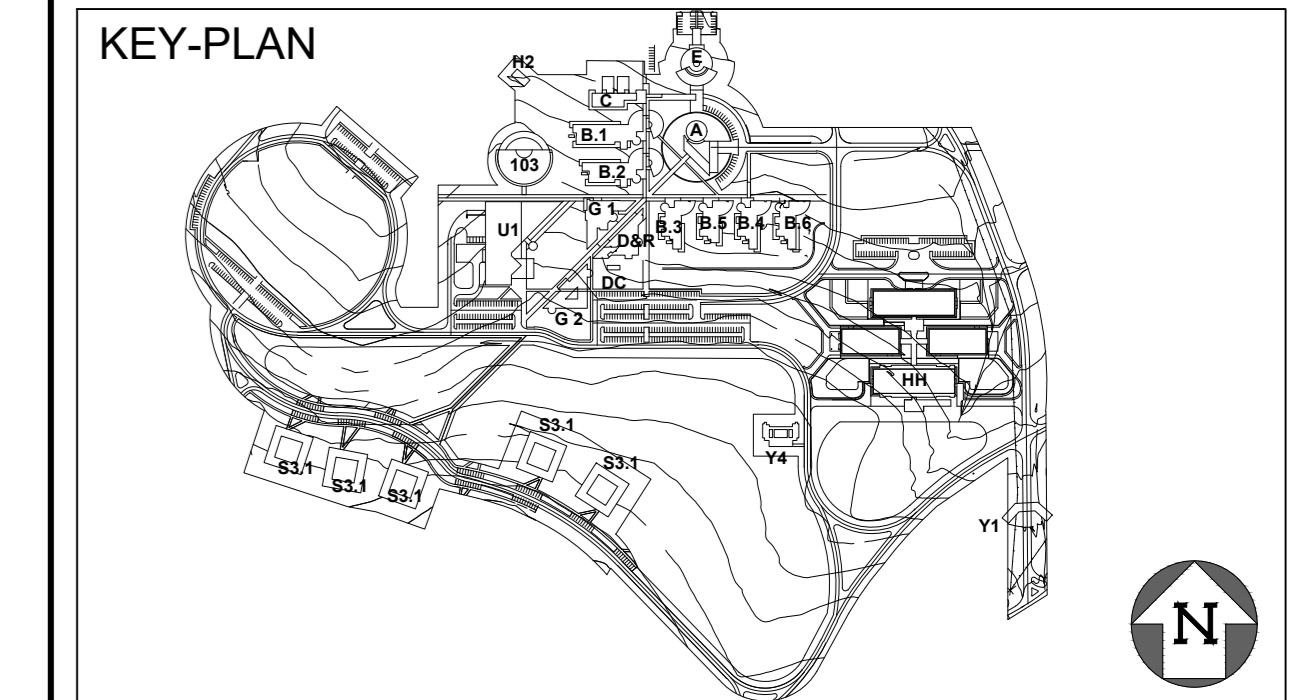

PURPOSE OF ISSUE				
DATE	REV. NO.	DESCRIPTION	NO. OF COPIES	TO WHOM

- GENERAL NOTES :-**
- 1) ALL DIMENSIONS ARE IN MILLIMETERS UNLESS STATED OTHERWISE.
 - 2) ALL LEVELS SHOWN ARE IN METERS UNLESS STATED OTHERWISE.
 - 3) ONLY WRITTEN DIMENSIONS SHALL BE FOLLOWED. THE DRAWING SHALL NOT BE SCALED.
 - 4) ALL DIMENSIONS INDICATE UNFINISHED SURFACES.
 - 5) THIS DRAWING SHALL BE READ IN CONJUNCTION WITH ALL RELEVANT ARCHITECTURAL, STRUCTURAL & SERVICES DRAWINGS & DISCREPANCIES / AMBIGUITIES IF ANY SHALL BE BROUGHT TO THE NOTICE OF THE CONSULTANTS BEFORE COMMENCEMENT OF THE WORK AT SITE.
 - 6) ALL LEVELS & DIMENSIONS STATED SHALL BE VERIFIED AT SITE & DISCREPANCIES/AMBIGUITIES IF ANY SHALL BE BROUGHT TO THE NOTICE OF THE CONSULTANTS BEFORE COMMENCEMENT OF THE WORK AT SITE.
 - 7) CONTRACTOR TO SUBMIT SHOP DRAWINGS OF GLAZING & ALL FACADE WORKS FOR CONSULTANTS APPROVAL BEFORE ORDERING OF MATERIALS & EXECUTION OF WORK.
 - 8) CONTRACTOR TO SUBMIT SHOP DRAWINGS & DESIGN CALCULATIONS FOR APPROVAL OF THE ARCHITECT & ENGINEERS.

DATE	NO.	DESCRIPTION	DRN BY	CHK BY	APP BY

REVISIONS

CLIENT

PROJECT

THE ROBERT MUGABE MILITARY TRAINING ACADEMY, ZIMBABWE.

TITLE

ADMINISTRATION COMPLEX BASEMENT FLOOR PLAN

PROJECT ID	STAGE	DOC TYPE	DRAWING NUMBER	REVISION
350010	P	DRG	A-A-20-0100	R0

SCALE	1 : 100	DATE:	15/11/2022
DRN BY:	BPC	CHK BY:	ADN
APP BY:	MPD	OFFICE OF ORIGIN:	MUMBAI

ACAD REF: 1) REF: (A) PROJECT 350010 - The Robert Mugabe Military Training Academy, Zimbabwe. (B) REF: (A) PROJECT 350010 - ADMINISTRATION COMPLEX BASEMENT FLOOR PLAN

NORTH

ISSUED FOR:

INFORMATION PURPOSE ONLY

ARCHITECT
ENGINEERING CONSULTANT
MEP CONSULTANT

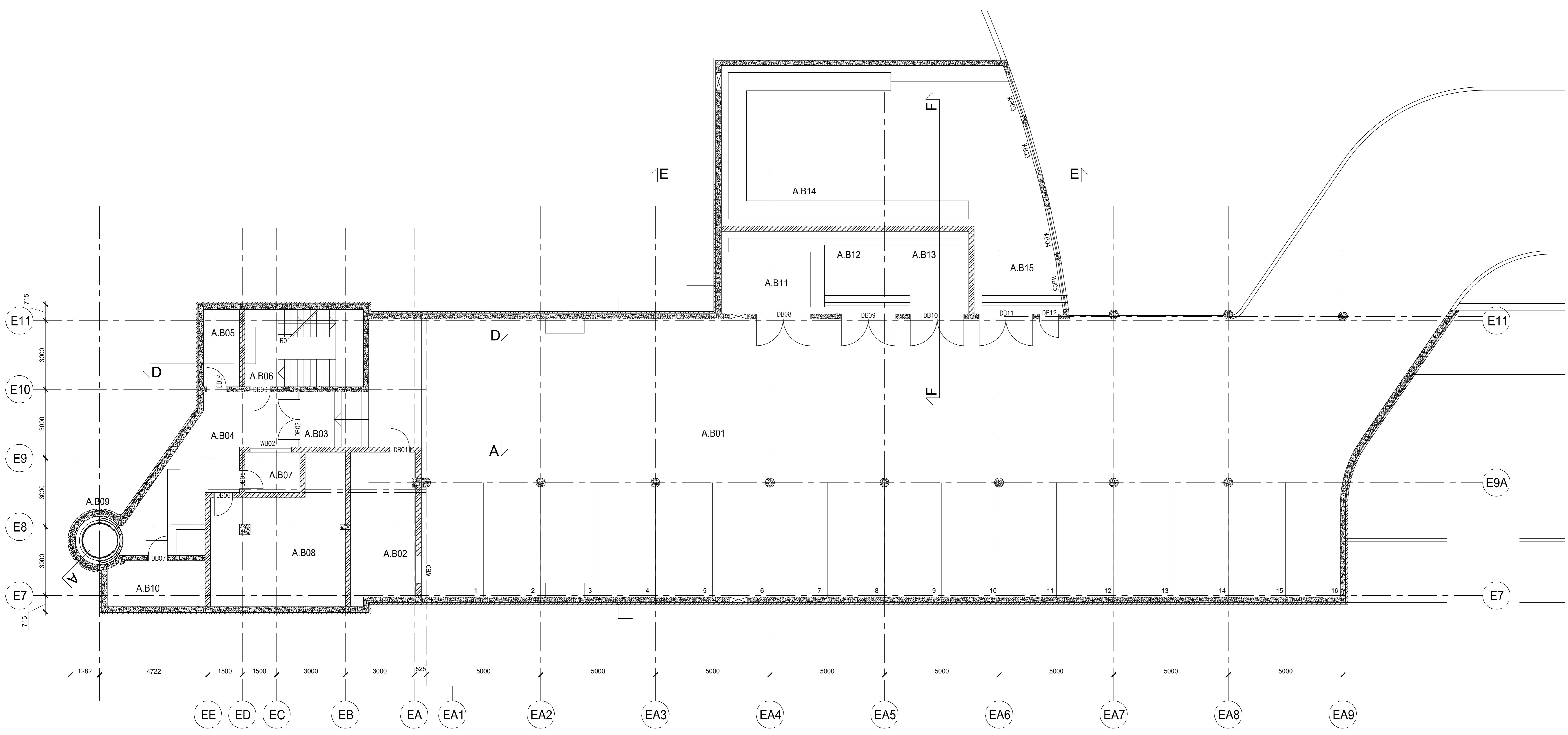

SCHEDULE OF FINISHES

CODE	DESCRIPTION	FLOOR	SKIRTING	WALLS	CEILING	CORNICE
A.B01	DRIVEWAY AND PARKING	F17	---	E1	E1	---
A.B02	ELECTRICAL ROOM	F2C	S2A	W1B	C1B	---
A.B03	ENTRANCE	F14	S8A	E1	C1A	---
A.B04	ENTRANCE LOBBY	F13, F13A	S8A	W1A,W8A	C4C,C9	---
A.B05	STORE	F2C	S2A	W1B	C1B	---
A.B06	FIRE STAIR	F2A	S2B	W1A,W8A	C1A	---
A.B07	SECURITY	F6B	S8A,S13	W1A	C4C	---
A.B08	STORE	F2C	S2A	W1B	C1B	---
A.B09	LIFT	F2A	---	---	---	---
A.B10	LIFT POWER ROOM	F2C	S2A	E1	E1	---
A.B11	HIGH VOLTAGE	F2A	S2A	W1B	C1B	---
A.B12	TRANSFORMER ROOM	F2A	S2A	W1B	C1B	---
A.B13	TRANSFORMER ROOM	F2A	S2A	W1B	C1B	---
A.B14	LOW VOLTAGE	F2A	S2A	W1B	C1B	---
A.B15	DIESEL GENERATOR	F2A	S2A	W1B	C1B	---